

Butt Purge Caps

Produced to ASTM D2513/D3261

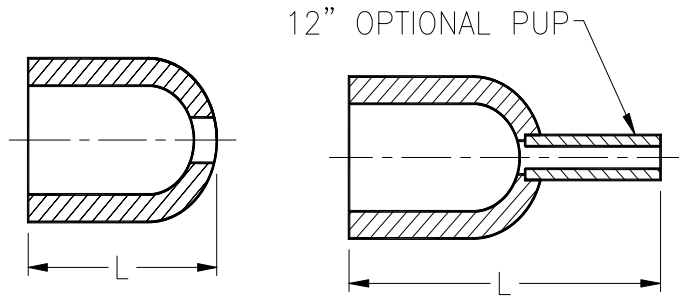

<u>Butt Purge Caps x Pup</u>	<u>CSA¹</u>	<u>DR/Wall</u>	<u>Dimension L (in)</u>	<u>Package Qty.</u>	<u>Package Weight (lbs.)</u>	<u>Reference Number</u>
2" IPS x 1/2" CTS	X	DR 11	16.25"	10	2.6	*F*BPC*
2" IPS x 1/2" IPS		DR 11				
2" IPS x 3/4" IPS	X	DR 11				
3" IPS x 1/2" CTS	X	DR 11	15.94"	10	5.6	
3" IPS x 1/2" IPS		DR 11				
3" IPS x 3/4" IPS	X	DR 11				
4" IPS x 1/2" CTS	X	DR 11-13.5	16.25"	10	9.0	
4" IPS x 1/2" IPS		DR 11-13.5				
4" IPS x 3/4" IPS	X	DR 11-13.5				
4" IPS x 1" CTS	X	DR 11-13.5				
6" IPS x 1/2" CTS	X	DR 11-13.5	17.20"	5	14.1	
6" IPS x 1/2" IPS		DR 11-13.5				
6" IPS x 3/4" IPS	X	DR 11-13.5				
6" IPS x 1" CTS	X	DR 11-13.5				
8" IPS x 1/2" CTS	X	DR 11-13.5	17.00"	1	4.3	
8" IPS x 1/2" IPS		DR 11-13.5				
8" IPS x 3/4" IPS	X	DR 11-13.5				
8" IPS x 1" CTS	X	DR 11-13.5				

¹ - CSA and IAPMO available as DriscoPlex[®] 6500 MDPE materials ONLY.

- Drawing No. CU70B365

Special precautions are necessary when working in gaseous environments or elevated temperatures. Consult your Operations and Safety Manuals for specific recommendations. The use of these tapping tees and cutters beyond this scope is at the user's own risk.